



ENZO



USER MANUAL

CHAIR PROVIDER: THIS MANUAL MUST BE GIVEN TO THE USER OF THIS WHEELCHAIR

CAREGIVER/USER: READ THIS MANUAL BEFORE USING THIS WHEELCHAIR AND SAVE FOR FUTURE REFERENCE

Product delivered may vary from the one described and pictured in this manual.

You have made a great choice by choosing a Leggero chair. We believe that every person should be able to function to the best of their ability. We welcome questions and comments about our products and services. Please contact us or an authorized provider using the information below.



Leggero
2802 South Water Street
Burnet, TX 78611
Toll Free: 1-844-503-KIDS
www.leggero.us

Authorized Leggero Provider:

Provider Name	
Address	
Phone	
Email	
Website	

Authorized European Representative:

EC	REP	MDSS GmbH Schiffgraben 41 30175 Hannover, Germany	CE
-----------	------------	---	-----------

NOTICE

Any serious incident that has occurred to the user and/or patient in relation to the device should be reported to the manufacturer and the competent authority of the Member State in which the user and/or patient is established

Table of Contents

Section 1: Introduction, Indications for Use, and Warnings	Page
1.1 Introduction	4
1.2 Intended Enzo User	4
1.3 Intended Enzo Attendant	4
1.4 Indications for Use	4
1.5 Intended Usage Environment	4
1.6 Warnings	5
Section 2: Labels	8
Section 3: Features, Adjustability, and Specifications	
3.1 Features	9
3.2 Adjustability	10
3.3 Specifications	10
Section 4: Unpacking Your Enzo Chair	11
Section 5: Operation and Adjustment	12
5.1 Wheel Locks	12
5.2 Seat Tilt Angle	13
5.3 Folding Operation	14
5.4 Hip Angle Adjustment	15
5.5 Backpost Adjustment	16
5.6 Backpost Height Adjustment	16
5.7 Seat Depth Adjustment	17
5.8 Swing Away Front Rigging Operation	18
5.9 Footbed Height Adjustment	19
5.10 Footbed Adjustment	19
5.11 Flip Up Armrest Operation	20
5.12 Single Post Armrest Operation	21
5.13 Using the Enzo as a Chair in a Motor Vehicle	22
5.14 Safe Operation in Daily Use	23
Section 6: Limited Warranty	26
Section 7: Service and Maintenance	27
Section 8: Specifications According to RESNA WC:2009, Annex A	31

Section 1: Introduction, Indications for Use, and Warnings

1.1 Introduction

Thank you for selecting the Enzo chair. This manual explains how to operate, adjust, and maintain your Enzo chair. The product as described is subject to technical alterations without notice.

We are sorry that we cannot offer this user information in a format, appropriate for use by visually impaired people. The visually impaired must contact an authorized Leggero provider to obtain information and instruction in the form of verbal communication and hands on training if necessary.

1.2 Intended Enzo User

Rehab wheelchairs and pediatric positioning systems are appropriate for children who are limited to a seated position and require mobility and positioning assistance. The intended population age range is less than 21 years old. Individuals who need such assistance can have a wide variety of diagnosis limiting their ability to achieve mobility without such a system. For maximum occupancy rating and additional specifications, reference section 8 of this manual.

1.3 Intended Enzo Attendant

Attendants who operate the chair must be visually, mentally, and physically capable of safely operating the chair under all circumstances. Attendants must read and follow all instructions provided in this manual.

1.4 Indications for Use

The Enzo pediatric wheelchair is intended for medical purposes to provide mobility to persons restricted to a sitting position.

1.5 Intended Usage Environment

This chair is intended for both indoor and outdoor use. Effort should be made not to expose the chair to extremely hot or cold environments for extended periods of time. The chair is intended for use on relatively level surfaces with less than a 5° slope and should always be on level ground with the wheel locks engaged when parked. If the chair is exposed to corrosive substances like saltwater, the frame should be washed with water and wiped dry as soon as possible.

1.6: Warnings

Read this Manual Completely Before Using

All caregivers and/or attendants must read this user manual prior to operating the wheelchair. Familiarize yourself with the handling and functions of the product prior to actual use. If there is any information in this manual that you do not understand, please contact your authorized Leggero provider for assistance.

Failure to follow instructions or comply with warnings in this manual could result in personal injury and/or damage to the Enzo wheelchair, potentially voiding the warranty.

Symbols Used on Product Warning Labels and in User Manual



WARNING!

The word “WARNING” or this symbol indicate practices that are unsafe or dangerous and could result in serious injury to the occupant and/or caregiver.



WARNING! READ INSTRUCTION MANUAL

Choose The Right Chair & Safety Options

In the mobility industry, there are several options available to meet the needs of the client. Make sure that your (and your provider’s) choice of chair and other options takes into account the client’s comfort, positioning, physical limitations, and hazards that may be encountered during daily use.



Warnings: Failure to Follow These Warnings Could Result in Serious Injury or Death

WARNING! All caregivers and/or attendants must read this user manual prior to operating the Enzo chair. Familiarize yourself with handling and functions of the product prior to actual use. If there is any information in this manual that you do not understand, please contact your authorized Leggero provider for assistance.

WARNING! Non-conventional use and/or handling of the product can be dangerous. The wheelchair is NOT safely suitable for skating, wheelies, or similar high speed or athletic activities. Swiveling front wheels can wobble at higher speed and can cause a sudden stop and tip over of the chair. For maximum safety use the wheelchair only at regular walking speed. Under no circumstance should you let go of the handlebar while pushing. Do not ever push the chair away.

WARNING! The initial set up of this wheelchair must be performed by a qualified technician.

WARNING! Procedures other than those described in this manual must be performed by a qualified technician.

WARNING! The weight carried by the Enzo chair must not exceed the total weight limit 185lb/83.9kg (Maximum occupant weight plus weight of accessories and/or items carried.) Disregard weight limits on seating systems that state higher weight limits.

WARNING! Adjustments made to the chair may affect stability, increasing the risk of tipping. Adjustments must be made by your authorized Leggero provider. See section 5.14 for guidance.

WARNING! Avoid getting the chair wet or storing the chair in damp environments. Excess moisture can cause rust or corrosion, which can result in component failure. If the chair is exposed to moisture, dry thoroughly.

WARNING! Do not leave the chair or child in the sun or near other heat sources since the surfaces on the chair may reach temperatures capable of burning the child. Do not leave the chair or child outside in cold temperatures because contact with a chair in temperatures below freezing could result in injury. Damage to the chair may also result from exposure to extreme hot or cold temperatures.

WARNING! The chair should only be used on solid and level ground. Do not attempt to push the chair over or into obstacles. Always remove the child from the chair when lifting chair to clear obstacles. Only operate the chair on the specified terrain.

WARNING! Do not use the chair on slopes steeper than 5 degrees. Do not leave the chair parked on a slope or an incline. Pay particular attention when on slopes and inclines to prevent the child from falling out of the chair, the chair from tipping over, or the chair from rolling away.

WARNING! Before leaving the chair and before getting into and out of it, always engage the wheel locks. Do not use the wheel locks to stop the chair while moving. Always fully extend a previously folded chair prior to use.

WARNING! Never leave your child unattended in the chair even if they are strapped in and the wheel locks are engaged.

WARNING! If the chair occupant reaches for objects in front, to the side, or behind the chair, be sure that they do not lean too far. The shift in the center of gravity might cause the chair to tip over.

WARNING! Do not stand on the footplate when transferring into or out of the chair.

WARNING! When folding the chair, be aware that there is a risk of injury through fingers becoming crushed or trapped.

WARNING! Straps from chest harnesses or lap belts can become trapped in the folding lock bracket. Please trim all straps as short as possible. Always ensure that frame is locked into upright position prior to resuming use. When unfolding, you will hear a “click” when the frame locks.

WARNING! The chair is only intended to carry one child at a time. Do not carry more than one child at a time.

WARNING! Only lift the chair by parts that are solidly attached. The chair should be lifted by the side frame members whenever possible. If folded, hold the chair by the lower side frame tubes. Always use two people for lifting to prevent injury and damage to the chair.

WARNING! Please keep packaging material away from children. Discard all plastic packaging material immediately after unpacking.

WARNING! If your chair is not equipped with the transit option, do not use it as a seat in a motor vehicle. Transfer the child from the chair to an approved motor vehicle seat. If your chair is equipped with the transit option, refer to the section 5.13 in this manual.

WARNING! The chair must be inspected and maintained per the chart in Section 7: Maintenance. Problems detected must be repaired prior to resuming use of the chair.

WARNING! Many of the fasteners used to construct the Enzo chair consist of a bolt with a nut that contains a nylon lock ring. These connections must be maintained and secured with the original equipment fasteners and properly adjusted. For proper adjustment of pivot points, consult your authorized service provider.

WARNING! The Enzo wheelchair can be adjusted with different front caster sizes, different rear wheel sizes, and different seat to floor heights. Please consult your authorized server provider for any questions related to these attributes. Do not adjust the height or the front to back position of the rear wheels.

WARNING! The Enzo wheelchair has an adjustable cross brace that can be adjusted to accommodate hip width growth. Do not attempt to adjust the cross brace. Please consult your authorized server provider.

WARNING! Keep hands, fingers, and other body parts clear of moving parts to avoid injury.

Section 2: Labels

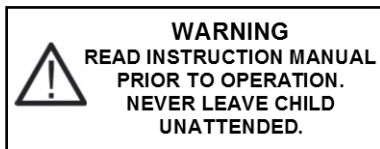

WARNING! Read Instruction Manual prior operation. Never leave child unattended.



WARNING! If your chair is not equipped with the transit option, do not use it as a seat in a motor vehicle. Transfer the child from the chair to an approved motor vehicle seat.



This label indicates that your chair is approved for use as a seat in a motor vehicle. See section 4.12 of this manual for further information.



This label indicates the location of the securement points (4) for transit use. See section 5.13 of this manual for further information.

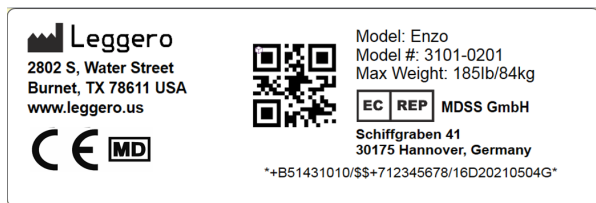

This label indicates the model name, model number (part number), maximum weight, and UDI.

The first 2 digits of the serial number indicate the year of manufacture.

UDI Number Breakdown (Sample)

+	B514	3101	0	/	\$\$+7	12345678	/	16D	20210204	G
HIBC Supplier Labeling Flag	HIBCC Assigned LIC Code	Version or Model Number	Unit of Measure	Data Delimiter	To be used to Indicate a Serial Number to follow	Serial Number (XXXXXXXX)	Secondary Supplemental Data Delimiter	Date of Manufacture Data Identifier	Manufacture Date (YYYYMMDD)	Check Character

Note: Version, serial number, manufacture date, and check character are altering variables.

A label on the tire indicates tire size.

Section 3: Features, Adjustability, and Specifications

3.1 Features

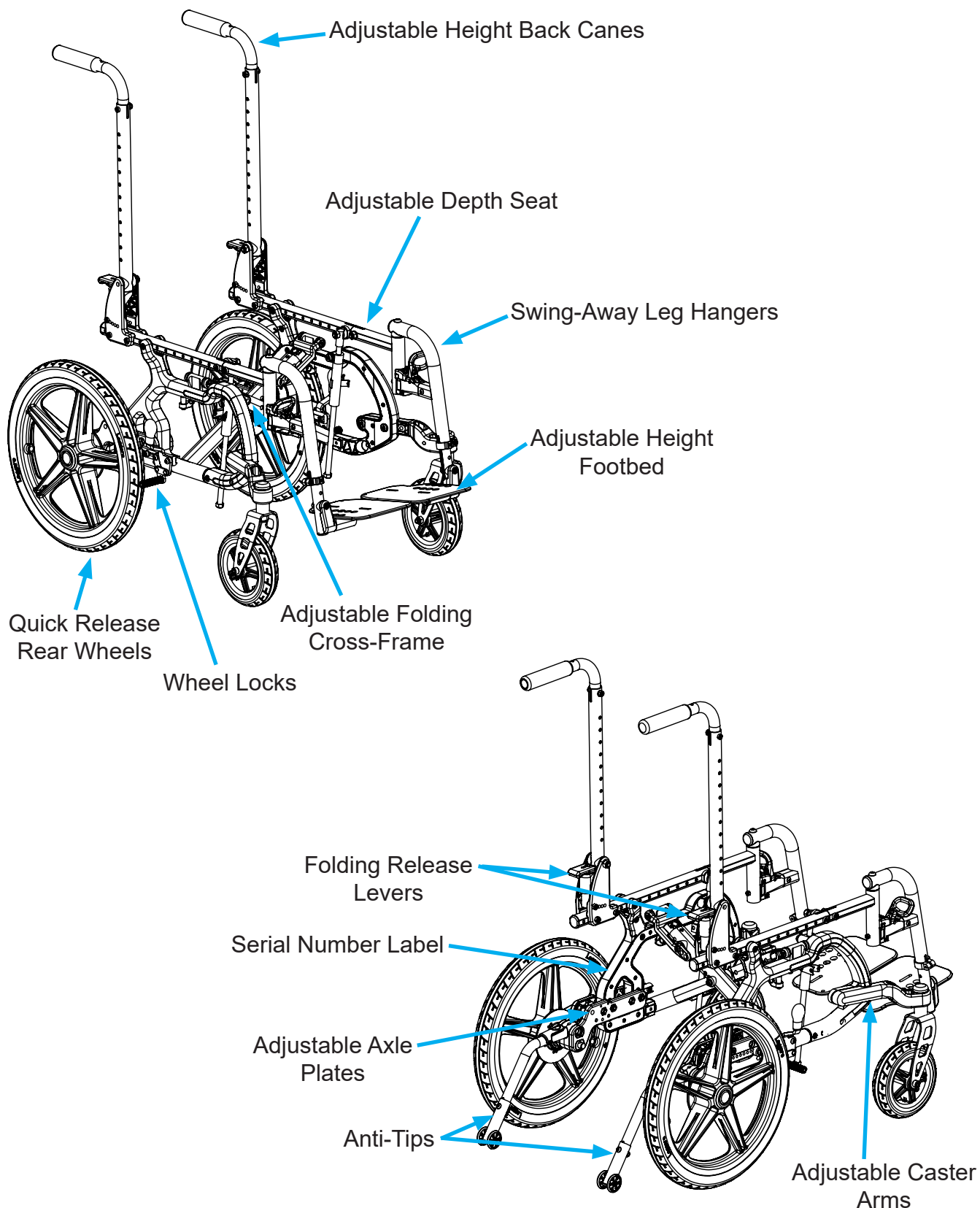

All Enzo models include the features shown above.

3.2 Adjustability

	<i>Enzo 12-14</i>	<i>Enzo 14-16</i>	<i>Enzo 16-18</i>
Seat Depth	11-16" (28-41cm)	13-18" (33-46cm)	15-20" (38-51cm)
Seat Width	12-14" (30-35cm)	14-16" (35-41cm)	16-18" (41-46cm)
Max Back Clamp Height	18" (46cm)	20" (51cm)	22" (56cm)
Hip Angle Adjustment	90-110°		
Seat Angle	-5° to 45°		

3.3 Specifications

	<i>Enzo 12-14</i>	<i>Enzo 14-16</i>	<i>Enzo 16-18</i>
Maximum User Weight	185lb (83.9kg)		
Mobility Base Weight	20lb (9kg)	22lb (10kg)	24lb (11kg)
Seat to Floor Height	13-18.5"		
Maximum Safe Slope	5°		

Section 4: Unpacking the Enzo Chair

1. Remove chair from packaging.
2. Discard all plastic packaging materials.
3. Unfold frame and seat back, reference Section 5.3 of this manual.
4. Install rear wheels, reference Figure 1.
5. Check for proper adjustment of quick release axles by pulling outward on wheel. Wheel should hold in place.
6. Engage wheel locks, reference section 5.1 of this manual.
7. Install anti-tips, reference Figure 2

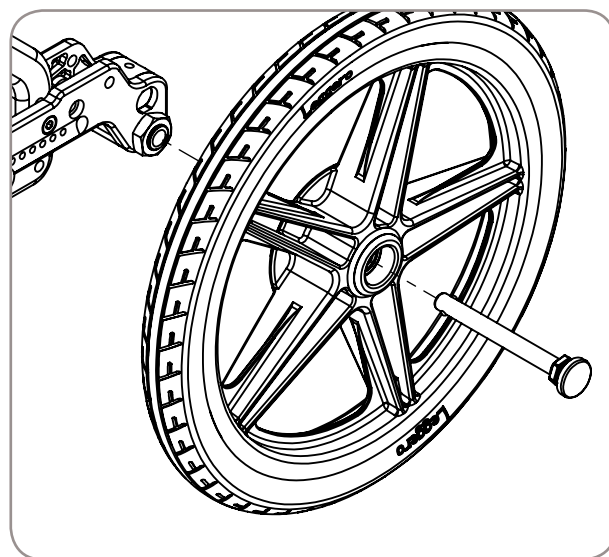

Figure 1



WARNING! Please keep packaging material away from children. Discard all plastic packaging material immediately after unpacking.

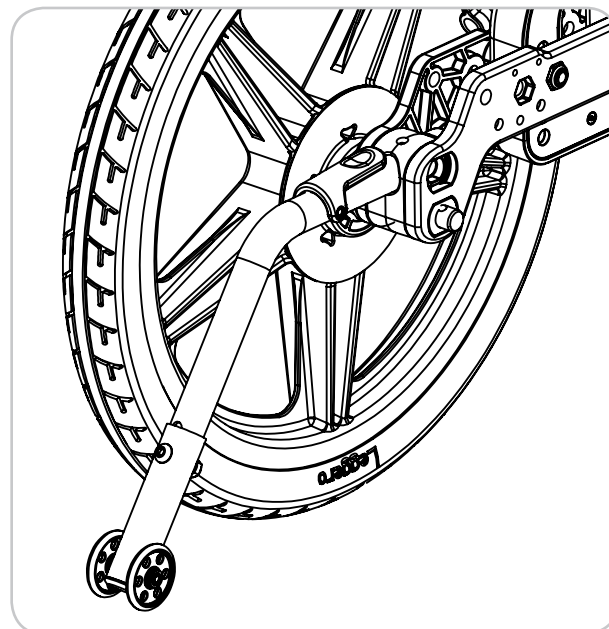
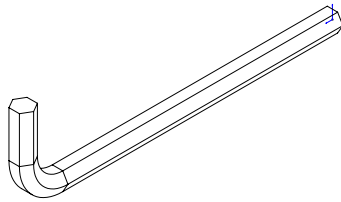

Figure 2

Section 5: Operation and Adjustment

Tools Required:



4mm & 5mm
Hex Wrench

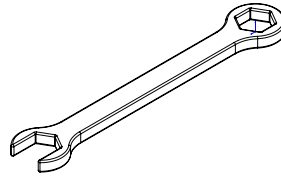

10mm, 13mm, & 22mm
Wrench

5.1 Wheel Lock Operation

1. To engage wheel locks, push handle down. Reference Figure 3.
2. To disengage wheel locks, pull handle up. Reference Figure 4.

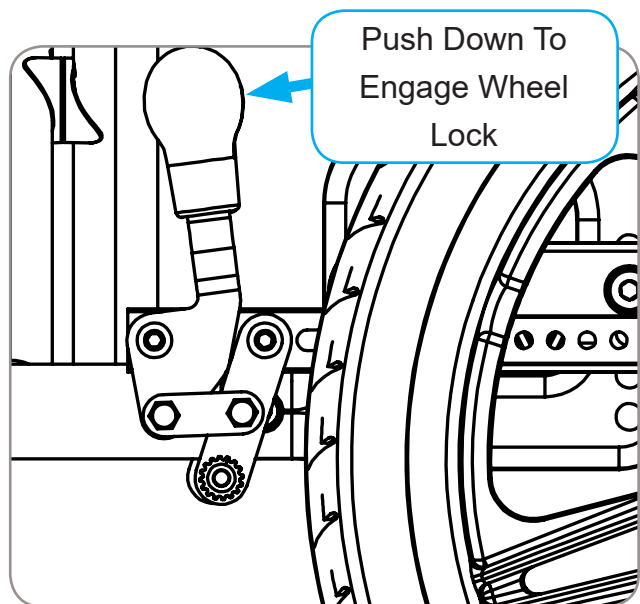

Figure 3

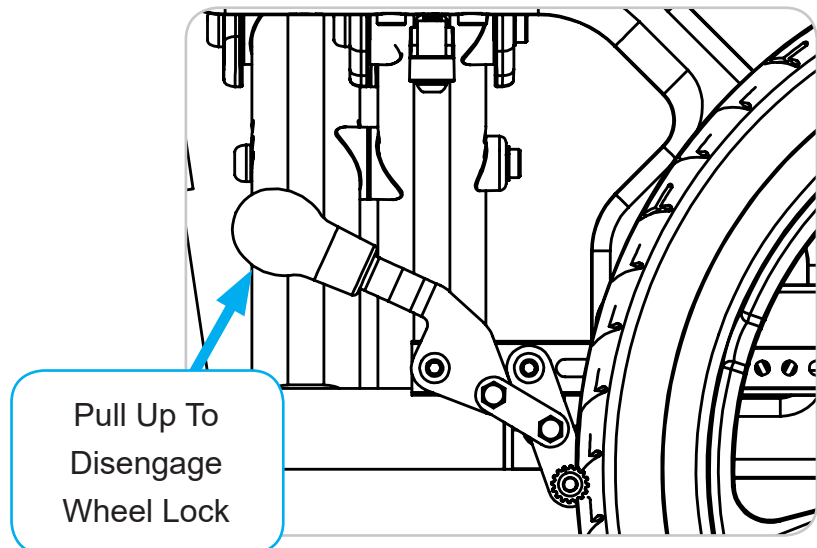

Figure 4

5.2 Seat Angle Adjustment

Foot Actuated Seat Angle Adjustment

1. Engage the wheel locks.
2. Grip push handles with both hands.
3. Press down on pedal. Reference Figure 5.
4. Adjust to desired seat angle.
5. Release pedal.



WARNING! Tilt cable tension should be checked periodically by an authorized Leggero provider. Do not attempt to adjust. Improper adjustment could result in a loss of control of the seat angle.

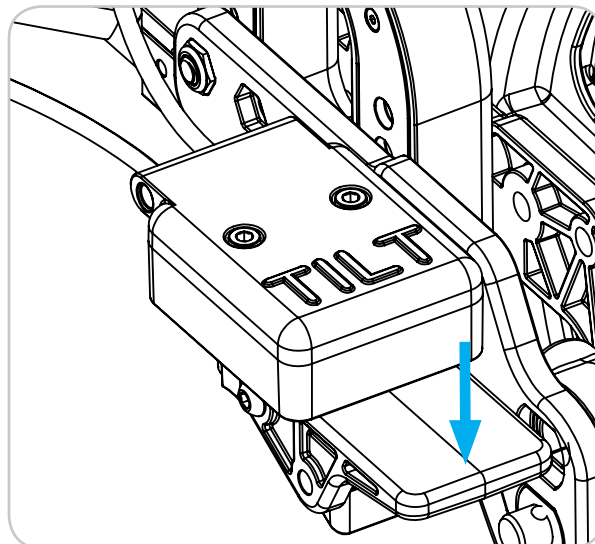

Figure 5

Hand Actuated Seat Angle Adjustment

1. Engage the wheel locks.
2. Grip the push handles with both hands.
3. Pull up on both tilt levers simultaneously.
Reference Figure 6.
4. Adjust to desired seat angle.
5. Release levers.



WARNING! Tilt cable tension should be checked periodically by an authorized Leggero provider. Do not attempt to adjust. Improper adjustment could result in a loss of control of the seat angle.

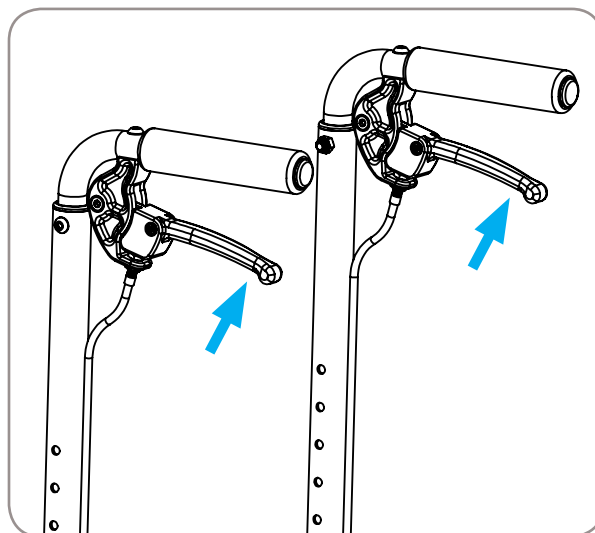

Figure 6

5.3 Folding

Folding

1. Engage wheel locks.
2. Adjust the seat angle to zero degrees.
3. Remove or flip up the armrests.
4. Remove seating.
5. Flip up the foot plates. Reference Figure 7.
6. Lift up on the backpost release levers and fold down the backposts. Reference Figure 8.
7. Pull up on the folding strap. Reference Figure 9.
8. Collapse frame. Reference Figure 10.

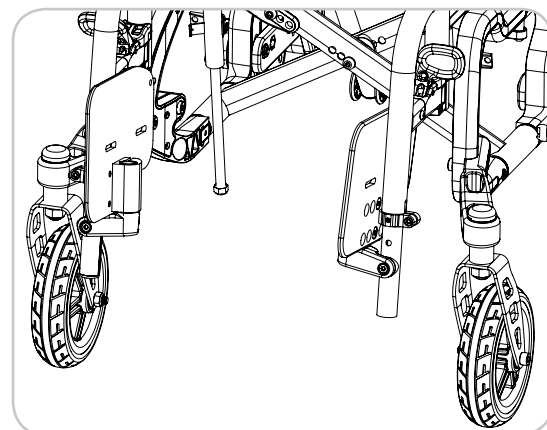

Figure 7

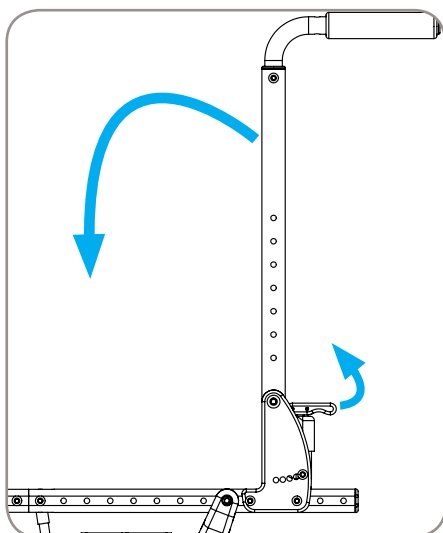

Figure 8

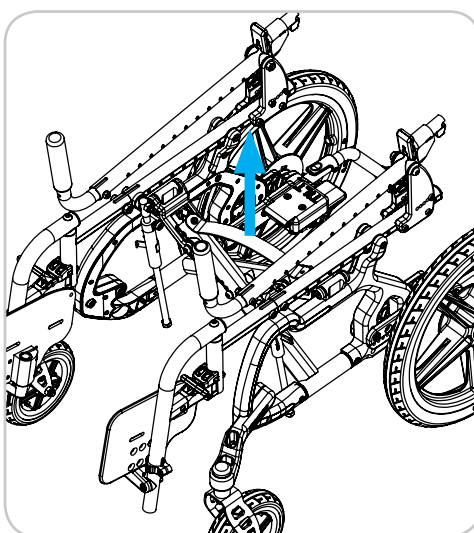

Figure 9

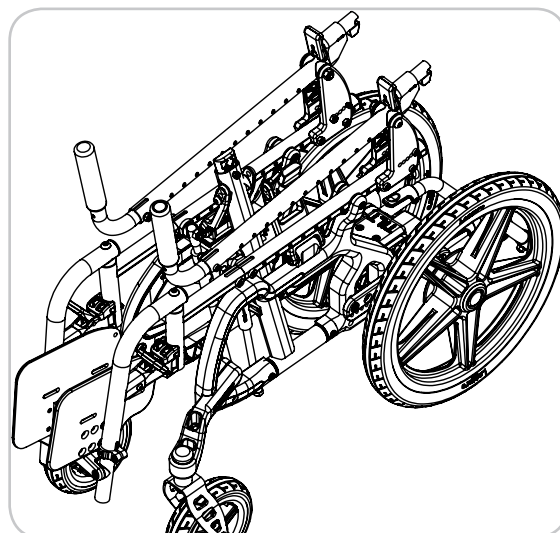

Figure 10

Unfolding

1. Push down and out evenly on the folding cross braces to fully expand the frame. Reference Figure 11.
2. Swing up the back canes until they snap into the locked position.
3. Install or flip down the armrests.
4. Flip down the foot plates.
5. Install seating.

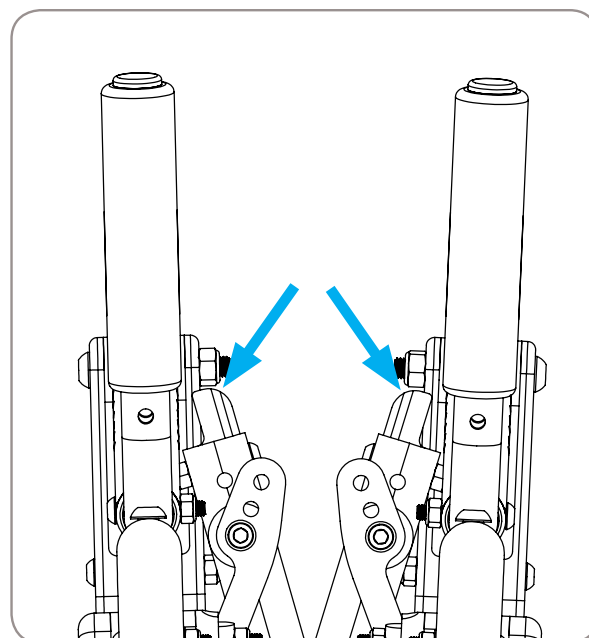

Figure 11

5.3 Folding Continued

Red Arrows indicate location of potential pinch points

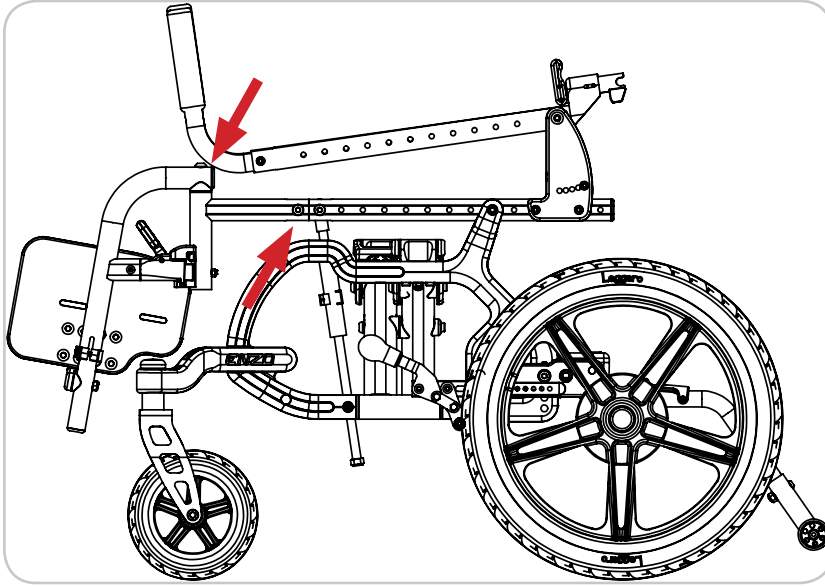

Figure 12



WARNING! When folding or unfolding, keep arms, hands, and feet clear of moving components to avoid injury. Reference Figures 12 & 13, arrows indicate potential pinch points.



WARNING! Straps from chest harnesses or lap belts can become trapped in the folding lock bracket. Please trim all straps as shortly as possible & attach lap belt buckles prior to folding.

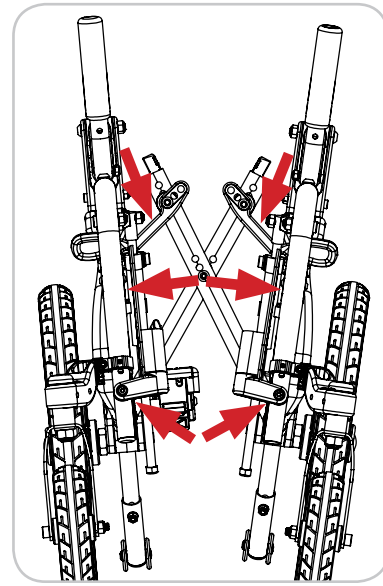

Figure 13

5.4 Hip Angle Adjustment

1. Engage the wheel locks.
2. Remove back cushion.
3. Fold down the backposts.
4. Using a 4mm hex wrench and a 10mm wrench, remove button head bolt and nyloc nut. Reference Figure 14.
5. Move latch bushing to the desired position.
6. Reinstall hardware. Tighten.
7. Swing up the backposts until they snap into the locked position.
8. Install back cushion.

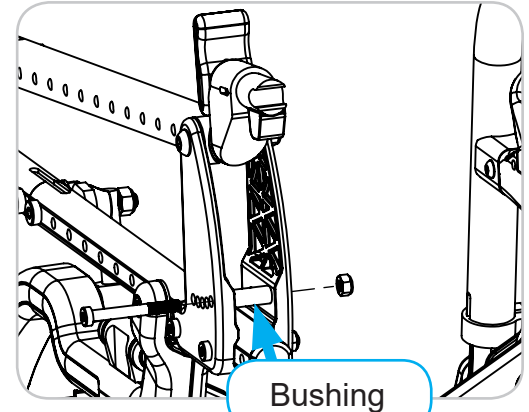

Figure 14



WARNING! Adjusting the hip angle position will affect the chair's center of balance. Always use anti-tips.



WARNING! Some after-market back cushions are equipped with hardware that can be used to adjust the hip angle. Do not adjust the seat to back angle beyond 110°

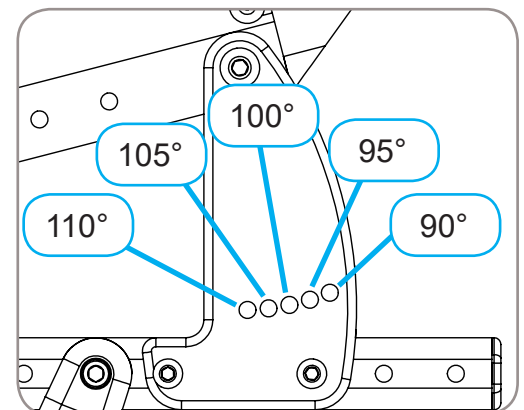

Figure 15

5.5 Backpost Adjustment

The position of the backpost can be adjusted front to back. This adjustment can accommodate different types of back hardware that might position the back surface further in front of the backposts. This adjustment is not intended for seat depth adjustment.

1. Engage the wheel locks.
2. Remove back cushion.
3. Using a 4mm hex wrench and a 10mm wrench, loosen the Hip Angle Adjustment bolt. Reference Figure 16, A.
4. Using a 4mm hex wrench and a 10mm wrench, remove attachment bolts.
5. Adjust backpost to the desired position.
6. Install and tighten attachment bolts.
7. Tight Hip Angle Adjustment bolt.

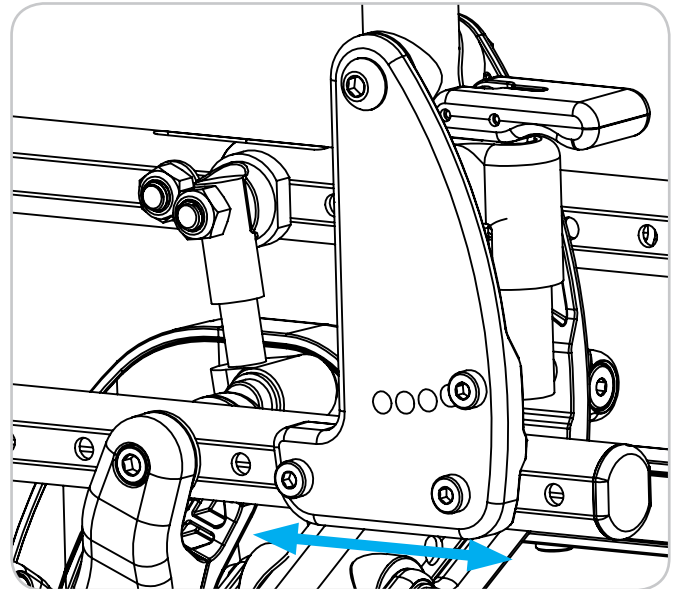

Figure 16



WARNING! Adjusting the position of the backposts will affect the chair's center of balance. Always use anti-tips.



WARNING! The contact surface of the back cushion must align vertically to the tilt pivot (within 1" [25.4mm] front or rear of pivot). If the back is not in this zone, the tilt angle will be difficult to adjust and the rear stability may be compromised. Always use anti-tips.

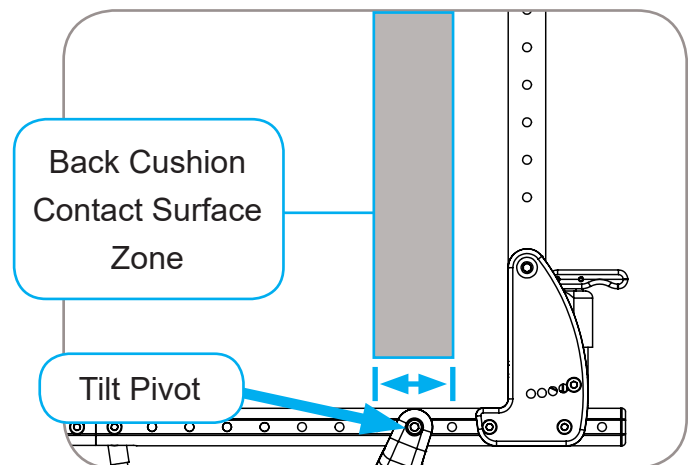

Figure 17

5.6 Backpost Height Adjustment

1. Engage the wheel locks.
2. Using a 4mm hex wrench and a 10mm wrench, remove bolt and nut.
3. Adjust the push handles to the desired height.
4. Install and tighten bolt and nut.

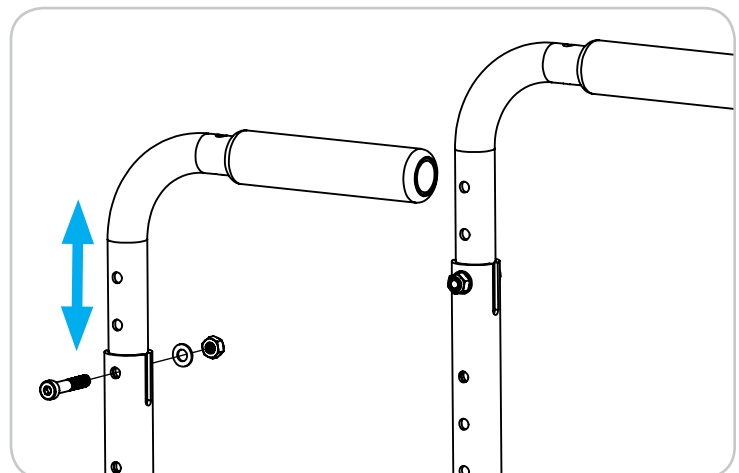

Figure 18

5.7 Seat Depth Adjustment

1. Engage the wheel locks.
2. Remove seat cushion.
3. Using a 5mm hex wrench and a 13mm wrench, remove bolt and nut. Reference Figure 19.
4. Adjust to desired depth.
5. Install and tighten hardware.
6. If seat depth needs to be longer than this adjustment allows, remove fasteners show in Figure 21. A 22mm wrench can be used to hold the nut on the inside of the tube.
7. Slide out the inner tube as needed. The last two holes in the inner tube must be inside the rear tube. Reference 22. Do not install the bolt in the last hole in the inner tube. Install and tighten hardware.
8. Install seating.

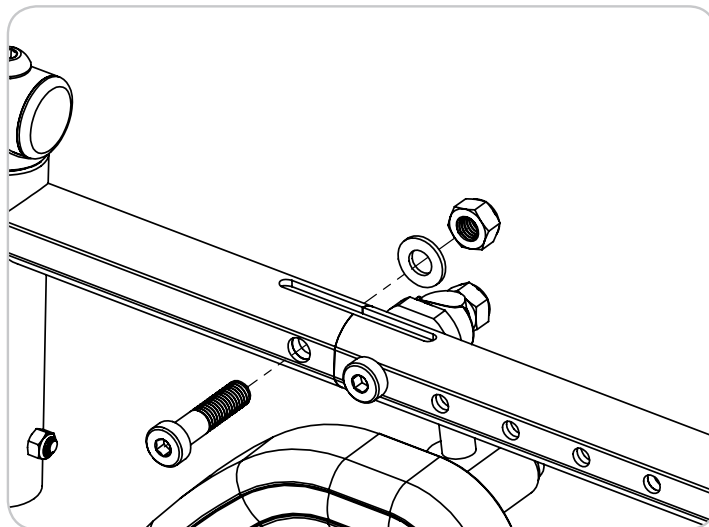

Figure 19

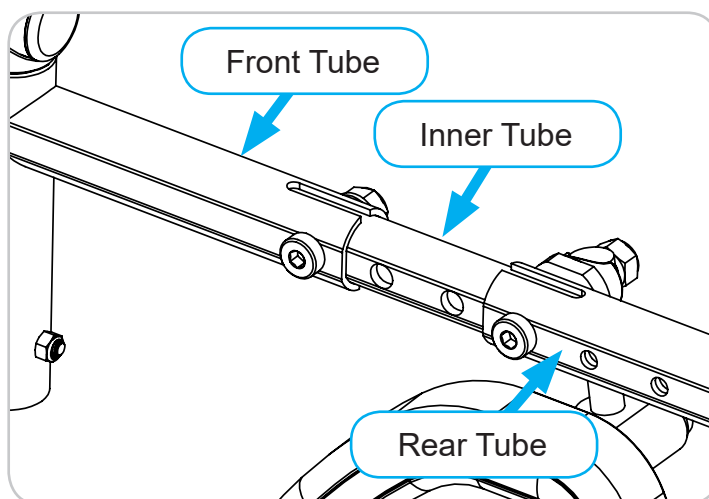

Figure 20

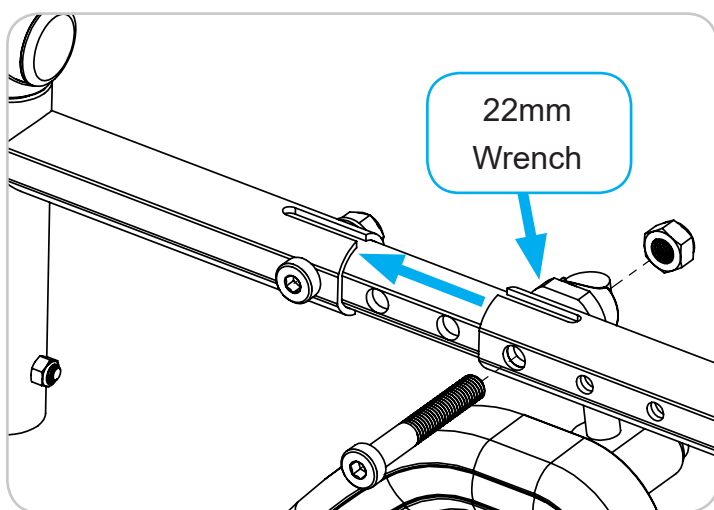

Figure 21

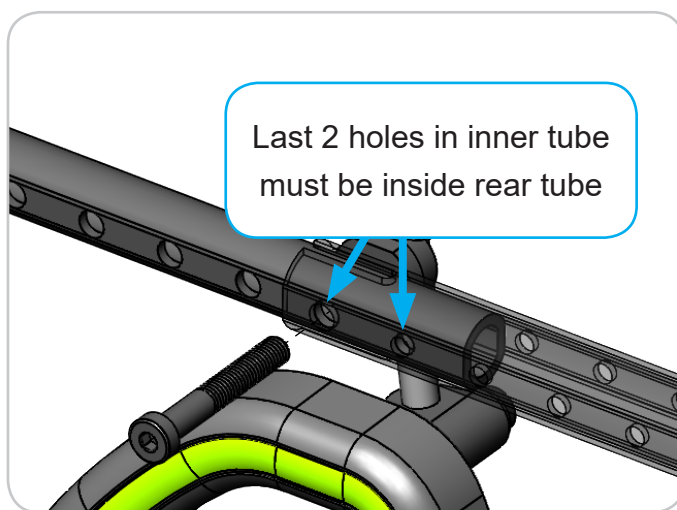

Figure 22

5.8 Swing Away Front Rigging Operation

Swing Away Function

1. Engage the wheel locks.
2. Pull release lever toward the back on the chair.
Reference Figure 23.
3. Swing out front rigging. Reference Figure 24.

Removal

1. Engage the wheel locks.
2. Flip up footplate and swing out front rigging as needed.
3. Pull release lever toward the back on the chair.
4. Pull up the front rigging and remove. Reference Figure 25.

Installation

1. Align front rigging with seat tube. Reference Figure 26.
2. Pull release lever toward the back on the chair.
3. Push on the front rigging until pin engages. Check engagement by trying to rotate from side to side.

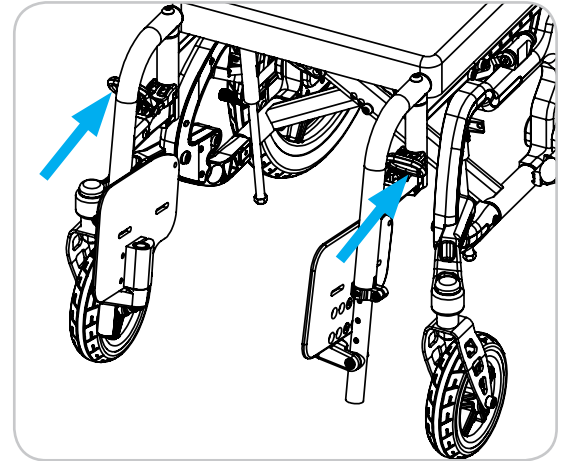

Figure 23

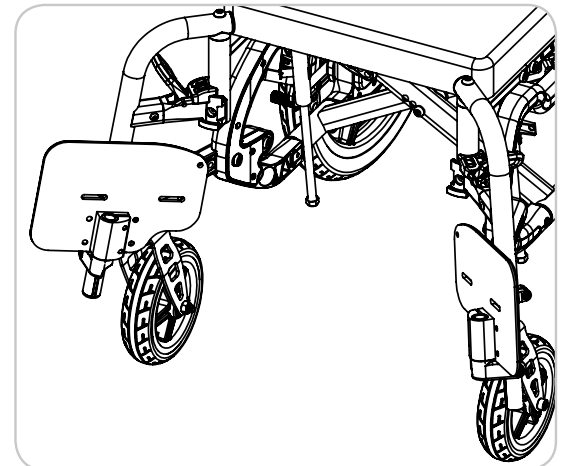

Figure 24

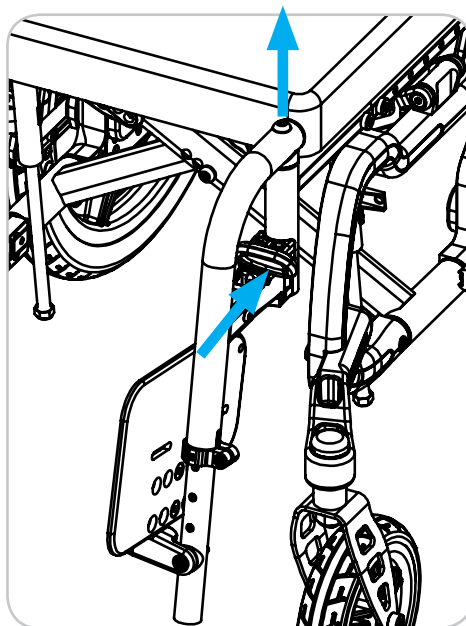

Figure 25

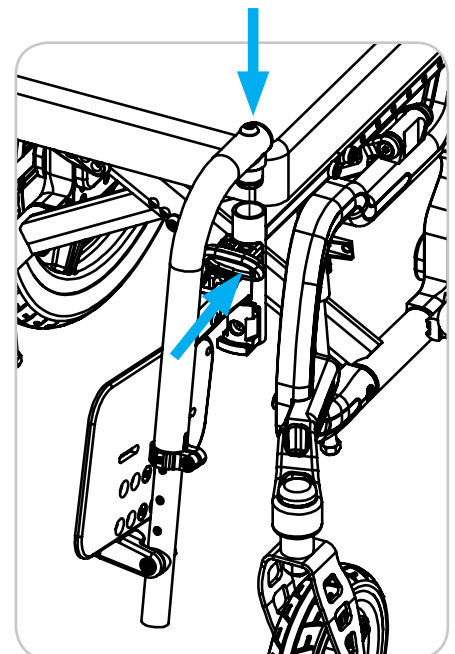

Figure 26

5.9 Footplate Height Adjustment

1. Loosen clamp bolt using a 4mm hex wrench.
Reference Figure 27.
2. Adjust footplate to the desired height.
3. Tighten clamp bolt.

For chairs equipped with shorter footplate heights, it will be necessary to move the footplate pivot down. Reference Figure 29.

1. Remove bolt and nut using a 4mm hex wrench a 10mm wrench. Reference Figure 28.
2. Adjust footplate to the desired pivot height.
3. Install and tighten bolt and nut.

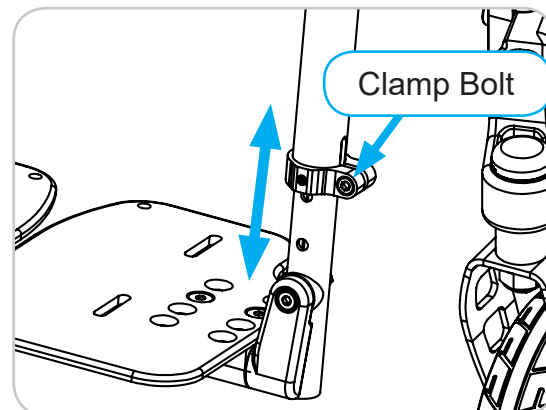

Figure 27

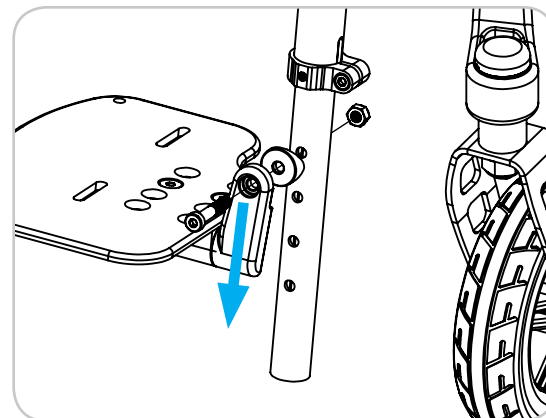

Figure 28

5.10 Footplate Adjustment

Adjustment Fore and Aft

1. Remove bolts using a 4mm hex wrench. Reference Figure 29.
2. Adjust footplate to the desired position.
3. Install and tighten bolts.

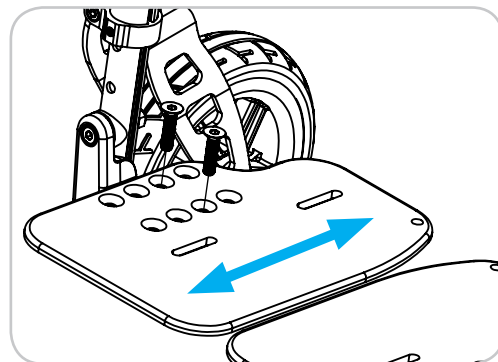

Figure 29

Angle Adjustment

1. Loosen bolts using a 4mm hex wrench.
2. Adjust footplate to the desired angle. Reference Figure 30.
3. Tighten bolts.

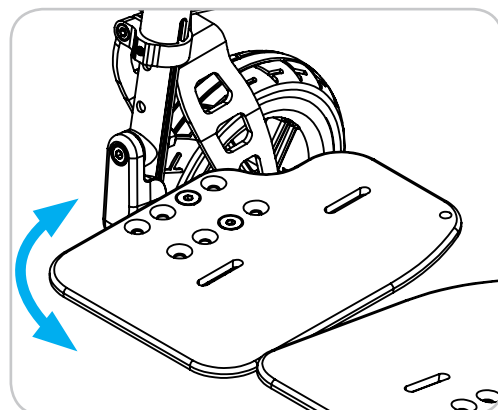

Figure 30

5.11 Armrest Operation

To Flip Up the Armrest

1. Pull release lever forward.
2. Pull armrest upward.

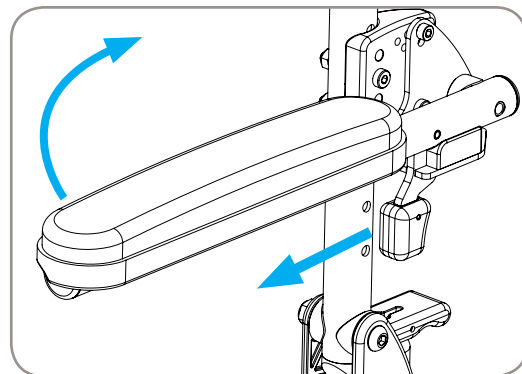

Figure 31

To Flip Down the Armrest

1. Push the armrest forward and down.

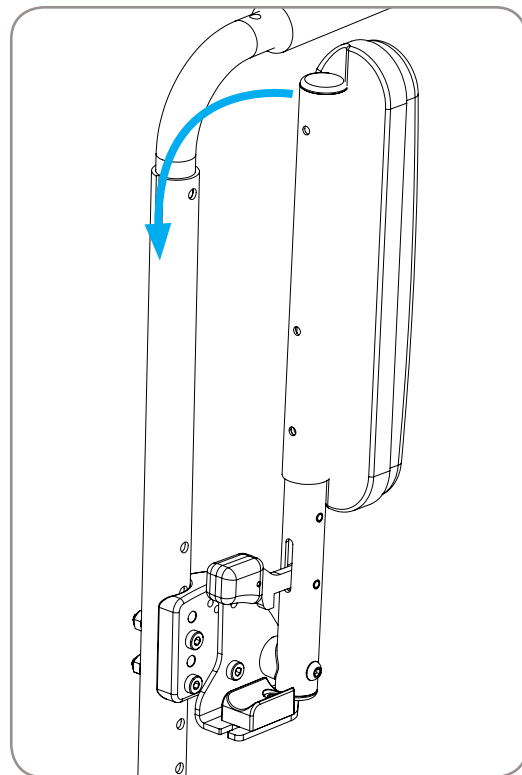

Figure 32

5.12 Single Post Armrest Operation

Height Adjustment

1. Pull out pull pin knob. Reference Figure 33.
2. Adjust armrest to the desired height.
3. Release pull pin knob.

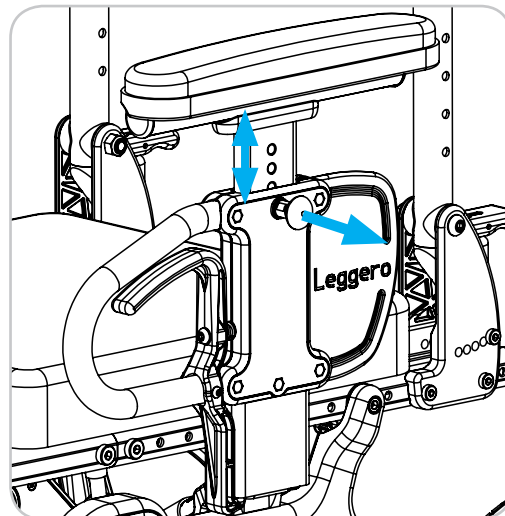

Figure 33

Armpad Position Fore and Aft

1. Pull out pull pin knob.
2. Remove Armpad assembly.
3. Loosen bolts using a 4mm hex wrench.
Reference Figure 34.
4. Adjust armpad to the desired position.
5. Tighten bolts.

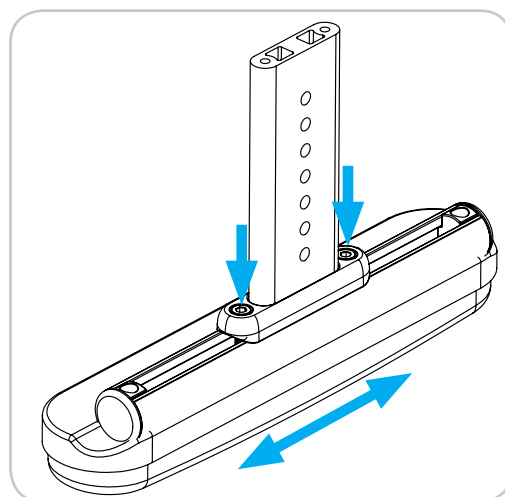

Figure 34

Armrest Removal

1. Pull lever rearward. Reference Figure 35.
2. Pull out Armrest.

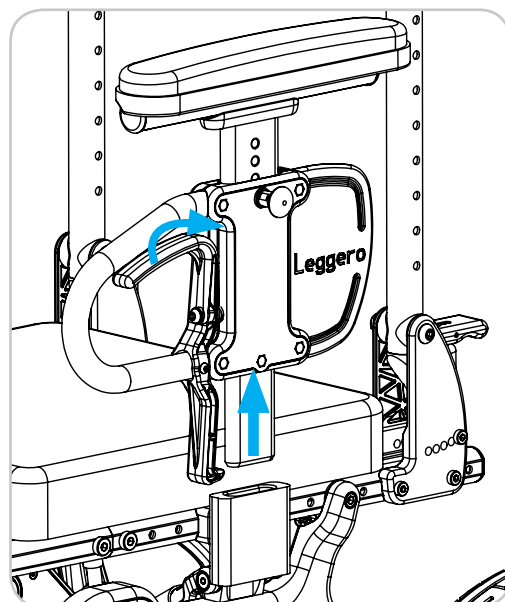

Figure 35

5.13 Using The Enzo Chair As A Seat In A Motor Vehicle



WARNING! If your chair is not equipped with the transit option, do not use it as a seat in a motor vehicle. Transfer the child from the chair to an approved motor vehicle seat.

The Enzo Chair is approved for transporting children in motor vehicles when it is equipped with the OPTIONAL transit feature and used in accordance with these instructions. The chair must be secured in a forward-facing position with a Wheelchair Tie-down and Occupant Restraint System (WTORS) which meets the requirements of SAE J2249 Recommended Practice—Wheelchair Tie-down and Occupant Restraint Systems For Use in Motor Vehicles.

IMPORTANT INFORMATION:

This chair conforms to and has been dynamically tested in compliance with ANSI/RESNA WC/Vol. 1 – Section 19.5.3. Please contact Leggero or your authorized Leggero provider if you have any questions regarding use of the chair for seating in a motor vehicle. Contact information can be found on page 2 of this manual.

WARNINGS & INSTRUCTIONS:

- The Enzo chair must be used as indicated in these instructions and the instructions supplied by the vehicle mounted tie-down manufacturer.
- Chair occupant should be transferred to the vehicle seat and use the vehicle restraint system whenever possible.
- Do not exceed maximum occupant weight ratings. Reference Section 1.7 of this manual.
- The Enzo Chair must be placed in a forward-facing position when used as a seat in a motor vehicle. Use an approved 4-point strap-type tie-down system for the chair. Use an approved 3-point belt for occupants over 50lb/23kg. For occupants under 50lb/23kg, a 5-point transit harness is required.
- For approved transit tie-down locations and location of belt/harness attachment pin, see Figures 36 and 37.
- Restraints must not be held away from the child's body by chair components or accessories.
- Belt or harness straps should be adjusted until they are snug and do not have slack. If you can pinch the webbing of the belt straps between your fingers, then it is too loose.
- Only belt restraints that comply with the provisions of ANSI/RESNA WC/Vol. 1 – Section 19 4.9.2-4.9.5 and 5.2 that have been dynamically tested in accordance with Annex A & 5.3 of the same, should be used on the chair for use as a restraint in a motor vehicle.

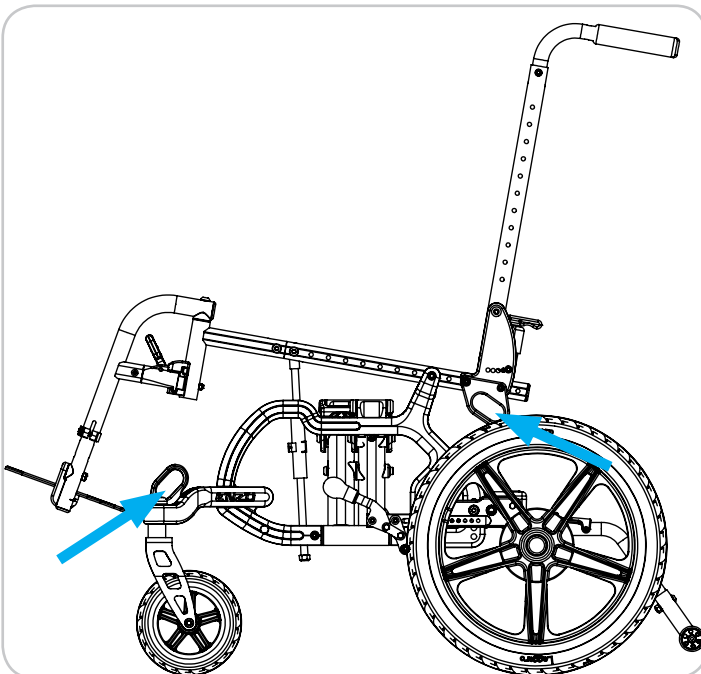

Figure 36

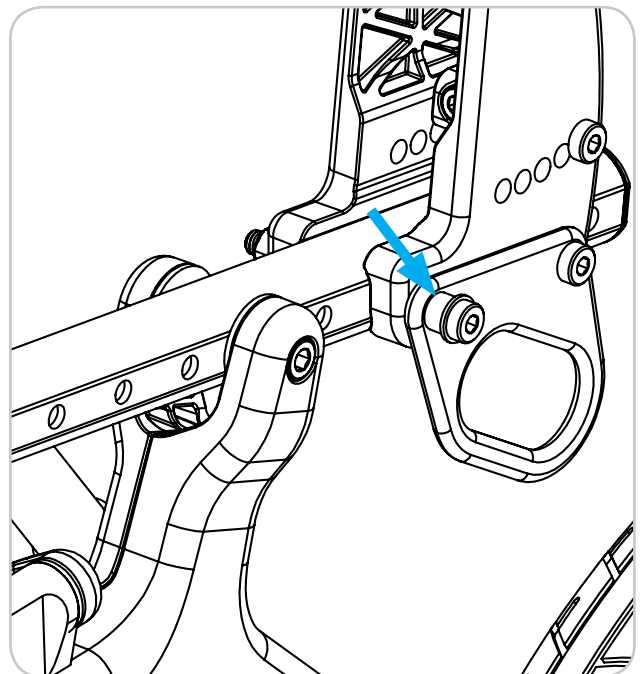

Figure 37, Belt/Harness Attachment

5.14 Safe Operation in Daily Use

Safely Using the Seat Tilt Angle Adjustment

For operation of the tilt mechanism, refer to Section 5.2



WARNINGS!

1. Do not attempt to adjust the seat angle without caregiver assistance.
2. If the wheelchair is on an inclined slope, do not attempt to adjust the tilt angle. Tilting the seat will decrease the rearward stability. Reference Figure 38. Do not use the wheelchair on any slope greater than 5°.
3. For caregiver assisted movement, do not adjust the angle of the seat below 10° posterior. Reference Figure 39.
4. For caregiver assisted movement, do not adjust the angle of the seat beyond 25° posterior. Reference Figure 40.

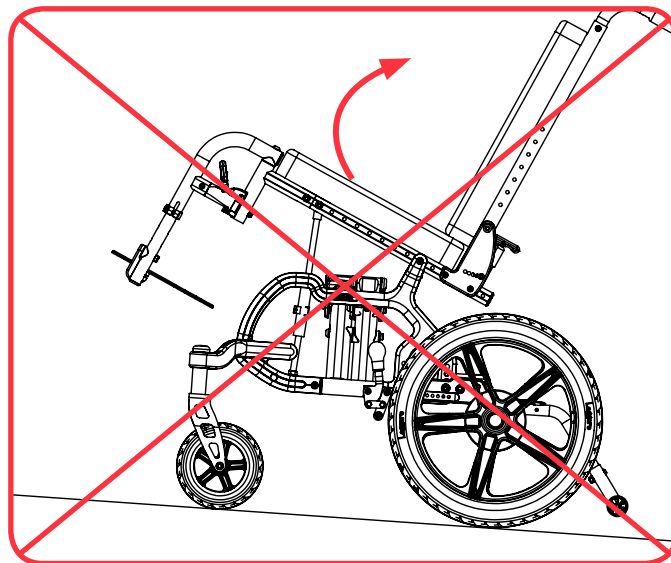

Figure 38

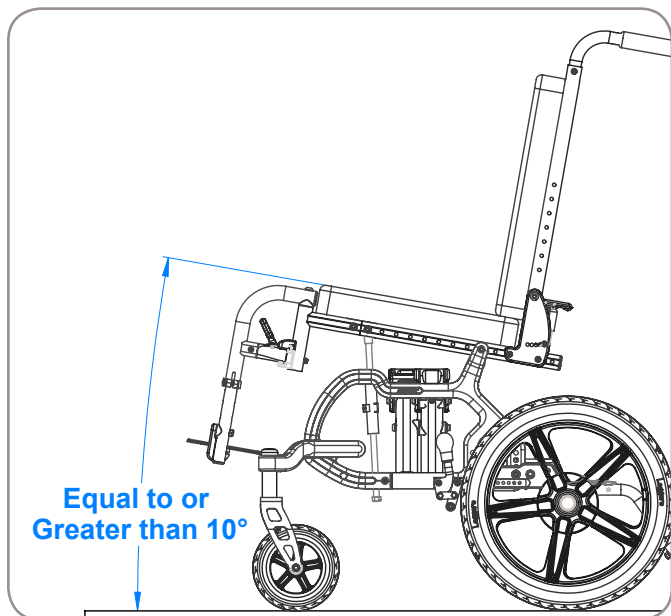

Figure 39

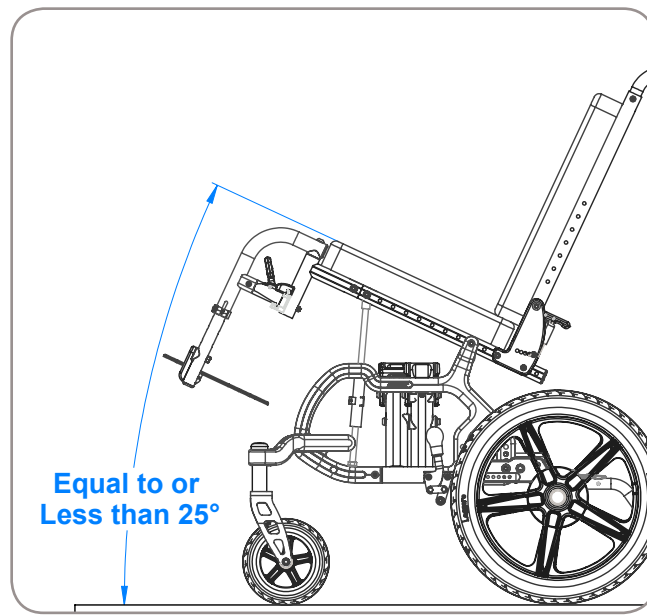

Figure 40



WARNING! Always use Anti-Tips

Obstacles



Figure 41



Figure 42

Inclines: Operate the chair on level ground whenever possible. Never operate the chair on slopes over 5°. When parking the chair, engage wheel locks. Never park on an incline. (Figure 41)



WARNING!

Never park on an incline!
Never operate on slopes over 5° (Figure 42)

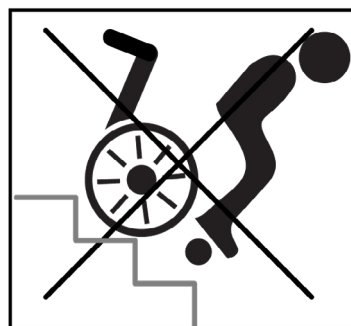

Figure 43

Stairs: Remove the child from the chair prior to going up or down stairs or escalators.



WARNING!

Do not use chair on stairs/escalators!
(Figure 43)

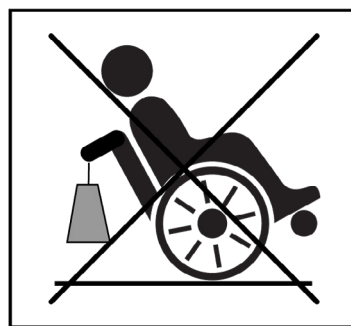

Figure 44



WARNING!

Never put weight on the back or push handle. It can cause the chair to tip over backwards.



Figure 45

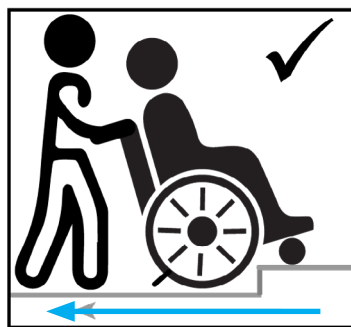

Figure 46

Up Curb: Face the chair forward and use the attendant handle to lift the front wheels off the ground up over the curb. Then roll forward and lift the rear wheel over the curb. (Figure 45)

Down Curb: Approach the curb backwards. Lower the rear wheel down the curb. Then use the attendant handle to lift the front wheels slightly and lower them off the curb. (Figure 46)

Reaching, Stretching, or Exercising: If the child must reach for something from the chair, move the chair as close as possible to the object and rotate the front casters until they are as far forward as possible. This may be accomplished by backing up along side the object. Stretching and Exercising should be done outside the chair whenever possible. If the task must be performed in the chair, similar caution must be used.

Transfers: Work with your health care provider to learn how to safely transfer and lift the child into and out of the chair. Transfer techniques vary based on the size of the child and level of ability.

For transfers, ALWAYS:

1. Ask for training if you don't know how to do a transfer.
2. Ask for assistance if needed.
3. Move the device as close as possible to the transfer destination.
4. Engage the wheel locks prior to starting the transfer.
5. When transferring into the device, make sure the user is seated as far back as possible.

Section 6: Limited Warranty

A. THIS WARRANTY IS EXTENDED ONLY TO THE ORIGINAL PURCHASER OF OUR PRODUCTS.

B. FOR LIFETIME

Leggero LLC warrants the frame and quick-release axles of this chair against defects in materials and workmanship for the life of the original purchaser. The expected life of this frame is five years.

C. FOR ONE (1) YEAR

We warrant all original equipment parts and components of this chair against defects in materials and workmanship for one year from the date of the first consumer purchase.

D. LIMITATIONS

1. We do not warrant:
 - Tires, tubes, upholstery, push handle grips, or arm pads.
 - Damage resulting from neglect, misuse, or from improper installation or repair.
 - Damage resulting from transit use.
 - Damage from exceeding the weight limit indicated on the serial number label.
2. This warranty is valid only when the product is used according to the specified conditions and the intended purposes, following all manufacturer recommendations. It is void otherwise.
3. This warranty shall not apply to problems arising from normal wear, and such evaluation will be solely determined by Leggero LLC.
4. This warranty is void if the product is modified without Leggero's express written consent including, but not limited to, modification through the use of unauthorized parts or attachments; products damaged by reason of repairs made to any component without specific consent of Leggero; or to a product damaged by circumstances beyond Leggero's control, and such evaluation will be solely determined by Leggero.
5. This warranty is void if the original serial number is removed or altered.
6. This warranty applies in the USA only. Check with your supplier if international warranties apply.

E. WHAT MANUFACTURER WILL DO

Our sole liability is to repair or replace covered parts. This is the exclusive remedy for consequential damages.

F. WHAT YOU MUST DO

1. Obtain from us, while this warranty is in effect, prior approval for return or repair of covered parts.
2. Return the product or part(s), freight pre-paid to Leggero LLC. Contact Leggero customer service at 1-844-503-KIDS for a return address and to obtain a return authorization number (RA#).
3. Pay the cost of labor to repair, remove or install parts.

G. NOTICE TO CONSUMER

1. If allowed by law, this warranty is in place of any other warranty, written or oral, express or implied, including a warranty of merchantability, or fitness for a particular purpose.
2. This warranty gives you certain legal rights. You may also have other rights that vary from state to state.



Section 7: Service and Maintenance

Repairs & Replacement Parts

The caregiver may perform common maintenance listed in the table at the end of this section; however, service and repair of permanently attached, worn, or broken parts must be performed only by authorized Leggero service providers. Please contact the dealer/provider that supplied your chair or contact Leggero for a referral.

Authorized providers only replace and install original Leggero spare parts. If you need any replacement parts for your chair, please contact the Leggero dealer from whom you purchased your chair. If the part is not under warranty, you will receive a cost estimate. A parts manual is not available to the end user. Your dealer will contact Leggero to determine if the chair needs to be shipped in for service. Leggero Authorized providers will not allow end users to perform potentially hazardous maintenance or repair operations. See Storage, Shipment, and Travel in this section if shipping is required. Please call Leggero customer service if you have questions.

Proper Maintenance & Inspection

Consistent maintenance will extend the useful life of your chair. Improper maintenance can significantly decrease the useful life of the chair.

It is important to periodically inspect the chair and components for damage. Look for spots that have worn or missing paint, holes without bolts, and sharp edges. In addition, verify that all 4 wheels sit squarely on a flat surface. Also, sometimes problems may be identified by rolling the chair freely on a flat surface for 6 to 10 feet (2-3 meters). If the chair veers left or right, it can be a sign of damage. All positioning components should be solidly attached to the chair. If you notice any loose or damaged parts, they should be tightened or replaced prior to resuming use of the chair.

The chair should be cleaned regularly and should be serviced by an authorized dealer at least once per year. Warranty may be affected if proper maintenance is not performed at the specified intervals. Please see the following table for recommended maintenance procedures and frequency. Use the maintenance record to document maintenance activities.

Storage, Travel, and Shipment

The wheelchair should only be stored in temperature controlled, low moisture environments. Confirm that all parts of the chair are clean and dry prior to placing in storage.

Use caution when traveling with the wheelchair. The wheelchair should always be handled with care and secured during travel. If the chair is equipped with the WC-19 transit system, see section 5.12 for instructions on how to transport the child in the chair when necessary. If the chair is not equipped with the WC-19 transit tie down system, the child must be removed from the chair and the chair must be secured in place separate from the child. For additional assistance, contact your Leggero provider.

Call your authorized Leggero provider if you need assistance with packaging and shipping your chair. They can order the appropriate box, shipping materials, and instructions from Leggero. If possible, keep the original shipping box and packaging materials in case you need to ship or store it later.

Maintenance Activity Table

To identify parts, see the diagram in section 3.1

Wear items are identified by an * (astrix) and may need to be replaced periodically.

Tool required for maintenance are identified in section 5.

Periodic Visual Safety Inspections <i>to be performed by caregiver</i> WITHOUT child in the wheelchair	Weekly	Monthly
Inspect wheels and casters for missing pieces or excess wear		✓
Verify wheel locks are operating properly by engaging the wheel locks and attempting to move the wheels and wheelchair	✓	
On a level smooth surface, without the child in the chair, push the chair forward and release it to glide. The chair should roll straight, it should not pull to one side.		✓
Visually inspect that all fasteners are in place and are not loose		✓
Remove wheels to inspect quick release axles. Wipe any buildup off the quick release axles then put the wheels back on the chair. Verify that the axles properly hold the wheels in place by pulling on the wheel. It should not come off.	✓	
Push down on the front of the seat to verify the tilt doesn't slip	✓	
Visually inspect all structural components for wear or damage		✓
Visually inspect all accessories for damage		✓
Verify that the tilt cable is properly adjusted. The hand or foot lever should move at least 3 cm before the seat can be tilted.		✓

If any of the above inspection points requires further attention, contact your authorized Leggero service provider.

We recommend that the chair be cleaned regularly:

- Clean all frame components and plastic parts using mild detergents only.
- Fabric parts may be washed. If using a washing machine, put them in a linen bag or pillow case. Air dry.
- In most cases, wiping with a damp cloth is sufficient.
- Do not use your chair in salt water as severe damage may result.
- Keep sand or other particles from damaging the wheel and caster fork bearings

Maintenance Record

Date	Service Provider	Technician	Description of Service



[illegible]

Section 8: Specifications According to RESNA WC:2009, Annex A

Leggero Element – Section 15 Annex A

Manufacture: Leggero
 Address: 174 D Shepherd Trail, Bozeman, MT 59718
 Model: Element
 Max Recommended Occupant: 83.9 kg (185.0 lb)

Standard Ref.		Disclosure information (RESNA)	12" Seat	18" Seat
Sec	Clause			
1	9.2	Static stability forward – wheels unlocked (manual wheelchairs only)	11.1 °	13.8°
	10.2	Static stability rearward – wheels unlocked (manual wheelchairs only)	8.7 °	9.2°
	11.2	Static stability anti-tip – wheels unlocked (manual wheelchairs only)	13.4 °	15.1°
	12.1	Static stability sideways – wheels unlocked (manual wheelchairs only)	14.3 °	19.8°
5	8.2	Overall length	919.5 mm	1046.5 mm
	8.3	Overall width	485.1 mm	637.5 mm
	8.5	Stowage length ²	558.8 mm	609.6 mm
	8.6	Stowage width ²	485.1 mm	637.5 mm
	8.7	Stowage height ²	596.9 mm	569.9 mm
	8.9	Total mass	20.2 kg	23.1 kg
	8.10	Mass of heaviest part ²	11.7 kg	11.8 kg
	8.11	Pivot width (required for wheelchairs with differential steering) (without feet)	1143.0 mm	1295.4 mm
	8.12	Reversing width (required for scooters) (without feet)	N/A	N/A
	8.15	Required width of right-angled corridor (without feet)	685.8 mm	850.9 mm
	7.3.2	Seat plane angle ¹	-8.0 ° min	42.0 ° max
	7.3.3	Effective seat depth	279.4 mm	508.0 mm
7	7.3.4	Effective seat width	304.8 mm	457.2 mm
	7.3.6	Seat surface height at front edge	533.4 mm	533.4
	7.3.7	Back support angle ¹	5 °	25 °
	7.3.8	Back support height	444.5 mm	622.3 mm
	7.3.12	Foot support to seat ²	241.3 mm	482.6 mm
	7.3.16	Leg to seat surface angle	98 °	98°
	7.3.17	Arm support height ²	165.1 mm	309.8 mm
	7.3.23	Front location of arm support structure ²	N/A	N/A
	7.3.25	Propelling wheel diameter and size including width ¹	274.3 mm x 40.6 mm	
	7.3.26	Horizontal location of axle ²	114.3 mm	139.7 mm
8		Static, impact and fatigue testing requirements (pass/fail) ¹	Pass	
16	4	Resistance to ignition – requirements (pass/fail) ^{1, 2}	Pass	

¹Applies to all seat sizes

² Not tested by Beneficial Designs Inc.



Leggero LLC
2802 South Water Street
Burnet, TX 78611
Toll Free: 1-844-503-KIDS
www.leggero.us